



SILVERCRETE™

PRECAST

STEP KIT ASSEMBLY INSTRUCTIONS

Revised: 01/06/2024



SCAN FOR
VIDEO GUIDE

GOTO: [HTTPS://WWW.SILVERCRETE.COM.AU/STEP-KIT-ASSEMBLY-INSTRUCTIONS/](https://www.silvercrete.com.au/step-kit-assembly-instructions/)

(08) 8280 9055 📞

SALES@SILVERCRETE.COM.AU ✉️

WWW.SILVERCRETE.COM.AU 🌐

11 HEASLIP ROAD, BURTON SA 5110 🏠

STEP KIT
PARTS

SETOUT
PLAN

OPTIONAL
STEP

STEP
1

STEP
2

STEP
3

STEP
4

MORE
INFORMATION

REVISED: 01/05/2024

STEP KIT PARTS

2 x Side Sleepers per Level



1 x Custom Bullnose Step Tread per Level

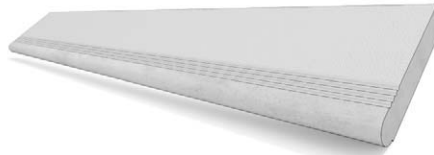

1 x Ground Level Riser (140mm)
(First level only)



1 x Step Riser (200mm) per Level
(From level 2 and up)



1 x L Bracket (Left Side), if 2 or more Levels

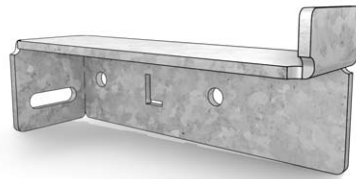

1 x R Bracket (Right Side), if 2 or more Levels



1 x LT Bracket (Left Top Side) for top Level

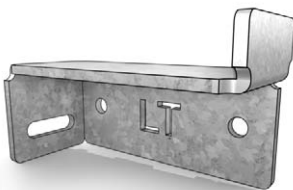

1 x RT Bracket (Right Top Side) for top Level

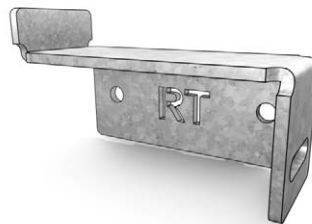

6 x M12 Galvanised Bolts per Level

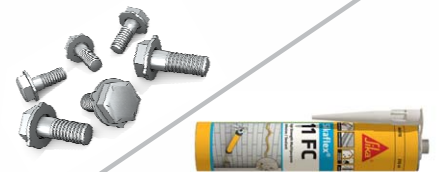

SikaFlex 300ml - 11 FC Adhesive x **1**

NOTE: Step Kits are NOT supplied with Steel Channels (sold separately).
Steel Channel lengths and type requirements will vary due to site specific conditions.

INSTALLATION TOOLS

- Spirit Level
- Spanner (for M12 bolts)
- Caulking Gun
- Concrete Cutting Saw (Optional)

STEP KIT SETOUT PLAN

» 2m Step Kit requires 2005mm spacing +5mm, -0mm

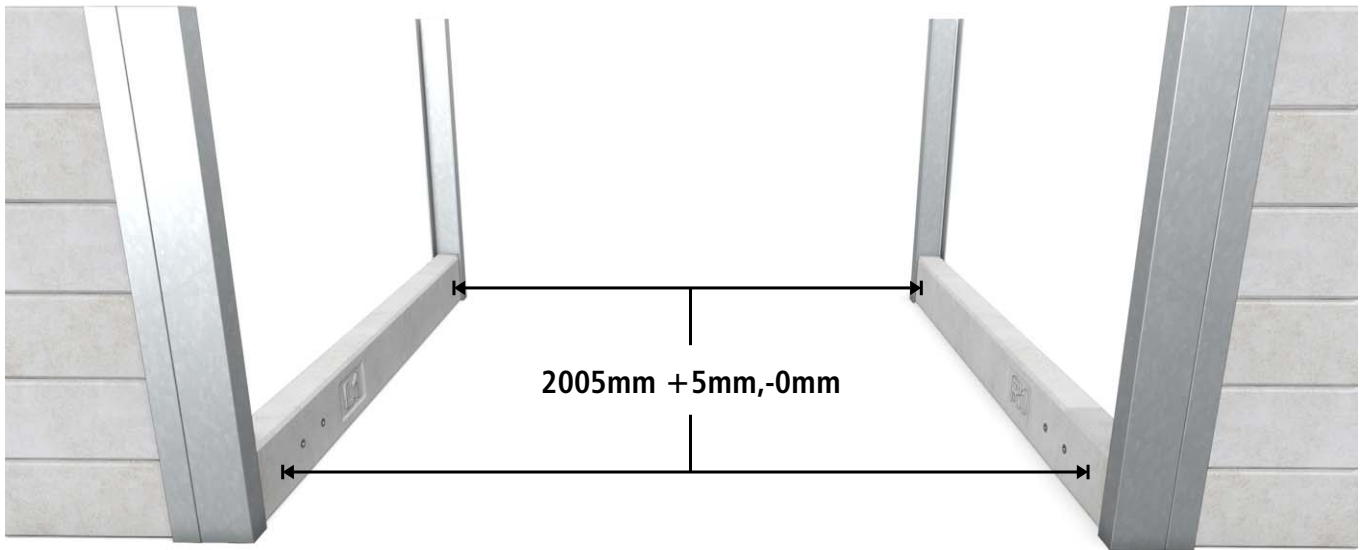

OPTIONAL: Cutting Side Sleepers to Length

Measure from back of Top Layer RT and/or LT Bracket 20mm + Steel Channel Flange length (X).

SEE: OPTIONAL STEP



PRO TIP:

Lower back channel to allow paver hard up against Side Sleeper

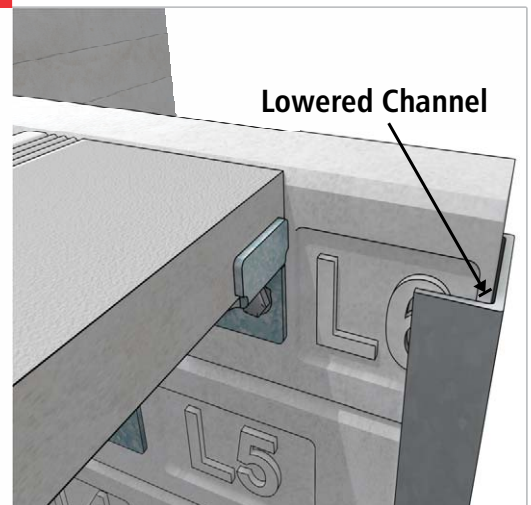
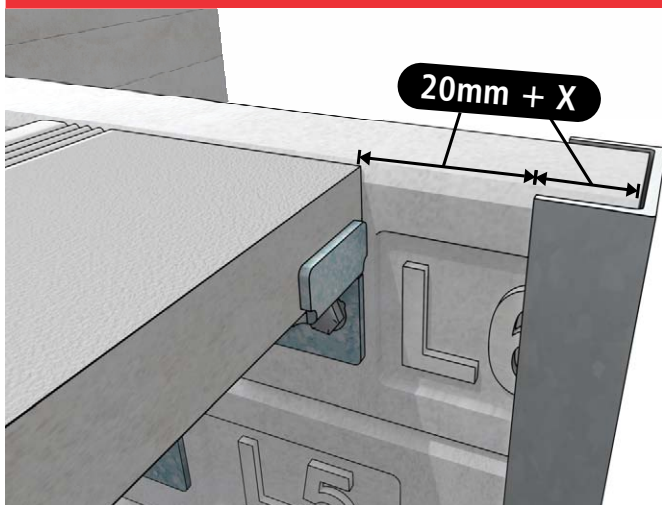

See Optional Page for more Instructions

CUTTING SIDE SLEEPERS TO LENGTH

When reviewing the Step Kit Setout Plan you may want to pre-cut your side-sleepers to the correct length before installing the steel channels. The following chart shows the predetermined length to cut the side-sleepers to, according to the number of steps you are installing.

EXAMPLE: The example is shown as if the flange width is 75mm.

3 High Step Kit - Top View

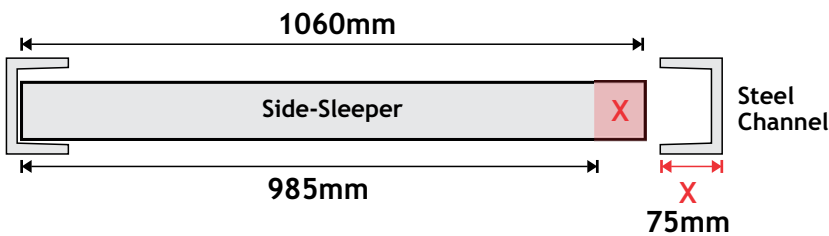

3 High Step Kit - Side View

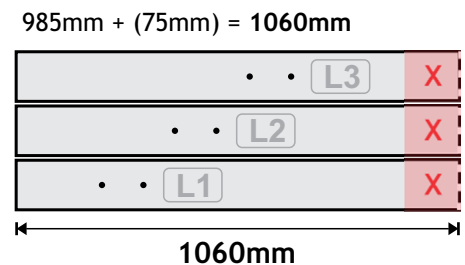

SIDE-SLEEPER, CUT LENGTH CHART

Use this chart length **PLUS** the flange width of the steel channel. Since this will vary depending on the channelling used, the flange width is shown as "X".

10 High Step =	(2875mm + X)	
9 High Step =	(2605mm + X)	
8 High Step =	(2335mm + X)	
7 High Step =	(2065mm + X)	
6 High Step =	(1795mm + X)	
5 High Step =	(1525mm + X)	
4 High Step =	(1255mm + X)	
3 High Step =	(985mm + X)	
2 High Step =	(715mm + X)	
1 High Step =	(445mm + X)	

NOTE:
Additional post required for 7 high kit and above.

FURTHER ASSISTANCE

If you require further assistance or have additional questions regarding this process, please do not hesitate to contact our helpful sales team on: **(08) 8280 9055**.

STEP 1

- » After installing steel beams as per **StepKit Setout Plan**, place the first two layers of **Side Sleepers**.
- » Ensure that the **Side Sleepers** are level and placed hard up against the steel channel.
- » Fasten **Brackets** using two M12 Galvanised Bolts.
- » Install **First Riser** (140mm) and fix by using 2 (two) M12 Galvanised Bolts.
- » Install **Next Riser** (200mm) and fix by using 2 (two) M12 Galvanised Bolts.

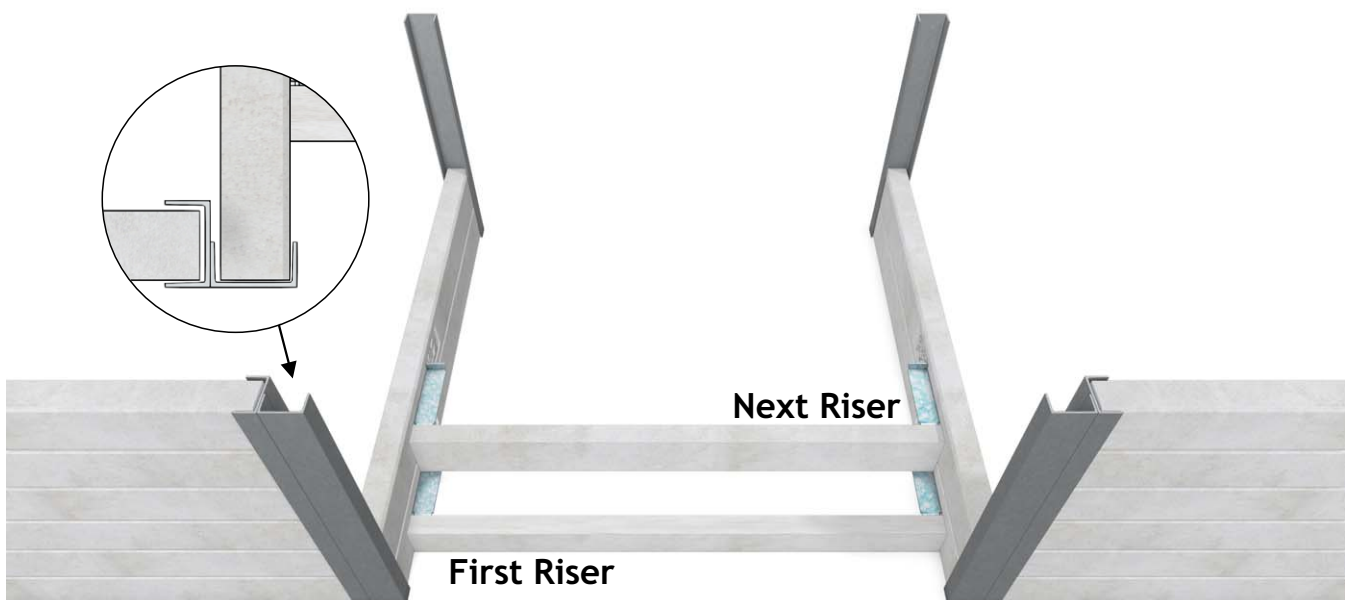

STEP KIT
PARTSSETOUT
PLANOPTIONAL
STEPSTEP
1STEP
2STEP
3STEP
4MORE
INFORMATION

REVISED: 01/05/2024

STEP 2

- A** Run a bead of SikaFlex FC11 or Equivalent on the brackets and back of the **Bullnose Step Tread**.
- B** Place **Bullnose Step Tread** on first **Step Riser**, slide back until contact with second **Step Riser**.
- C** Backfill the completed layer.

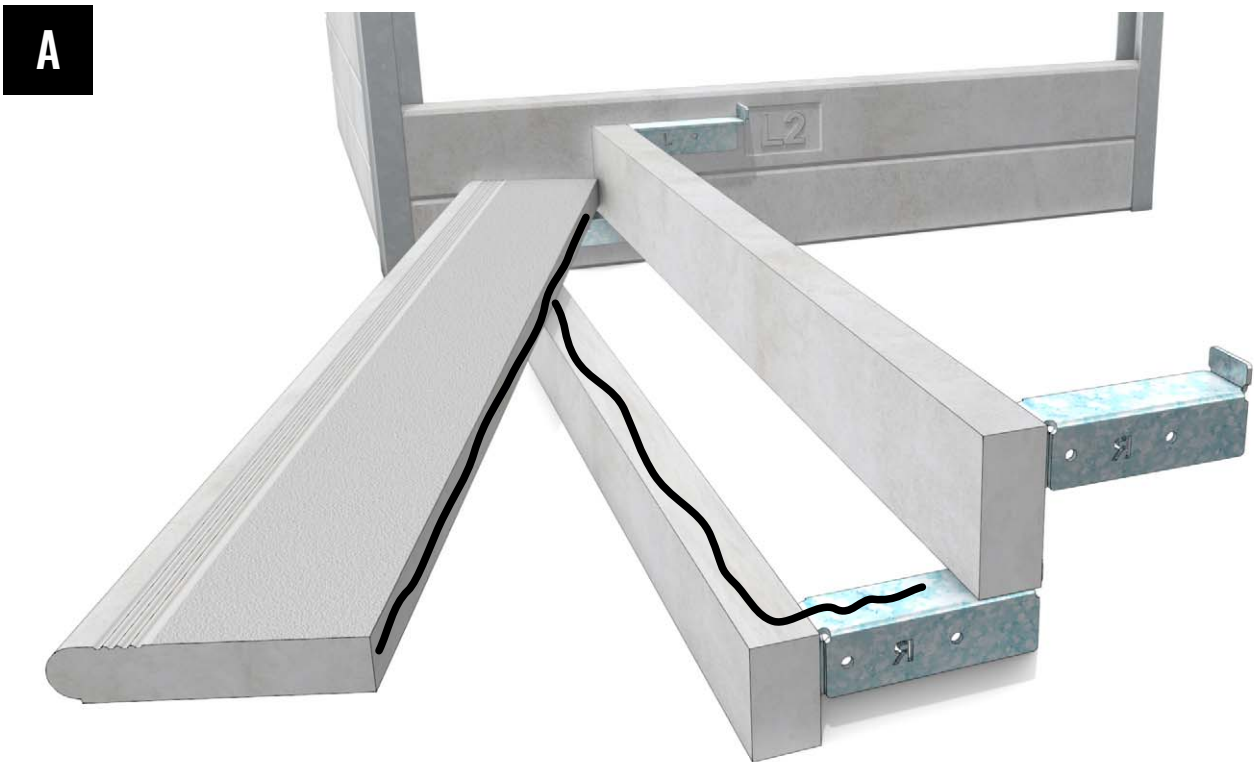

Place the **Bullnose Step Tread** on **Step Riser**



Backfill the completed layer.

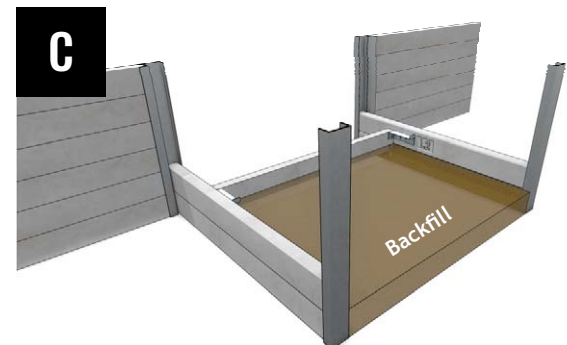

STEP 3

- » Place the next layer of **Side Sleepers** and install corresponding brackets.
- » Ensure that the sleepers are level and placed hard up against the steel channel.
- » Install the next **Step Riser** as per **Step 1** and repeat **Step 1** and **Step 2** until Top Layer.

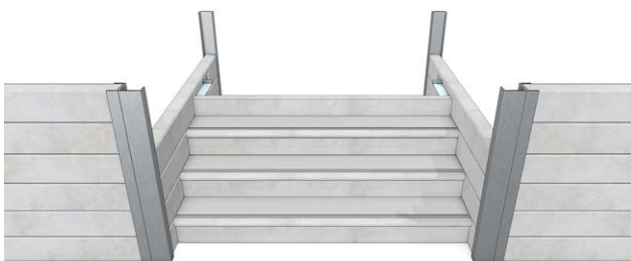
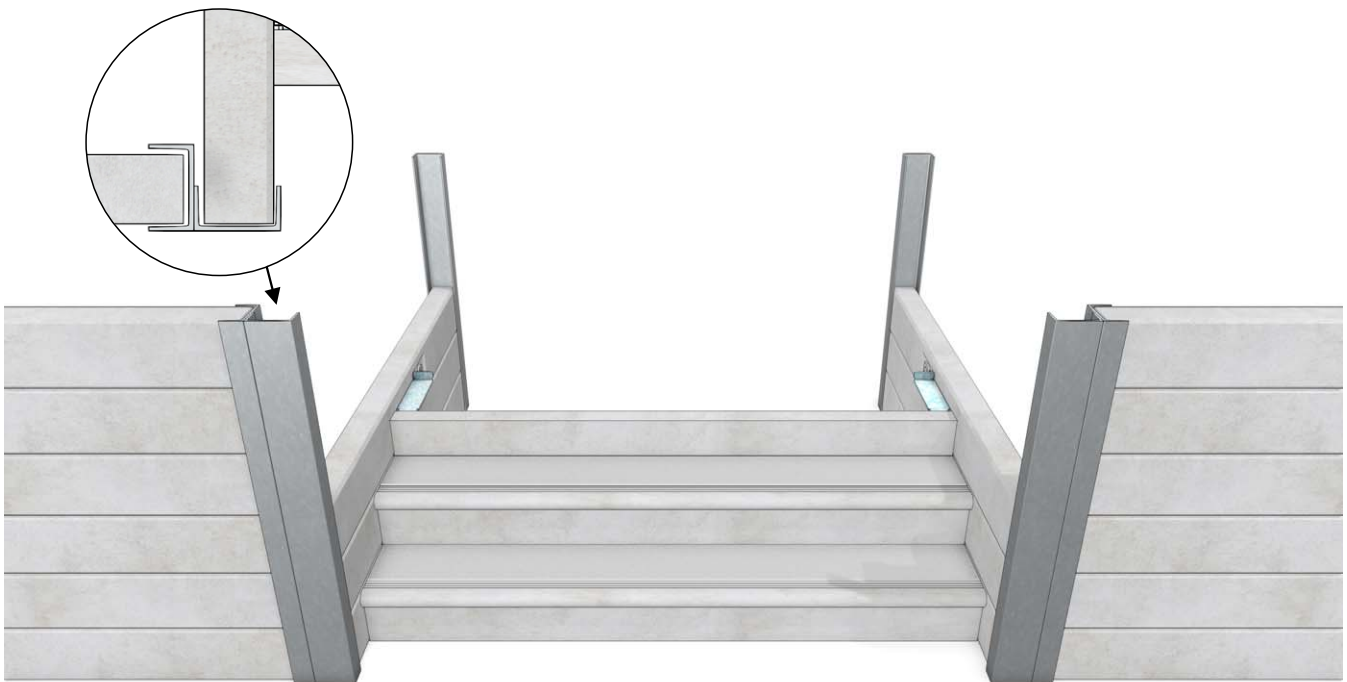

Repeating Step 2 and 3



Repeating Step 2 and 3

STEP 4

- » Place the Top Layer of Side Sleepers and install brackets LT and RT.
- » Install the final riser and secure with the final 2 (two) M12 Galvanised Bolts.
- » Install the final Bullnose Step Tread and affix with SikaFlex FC11 or Equivalent as per **Step 2**.

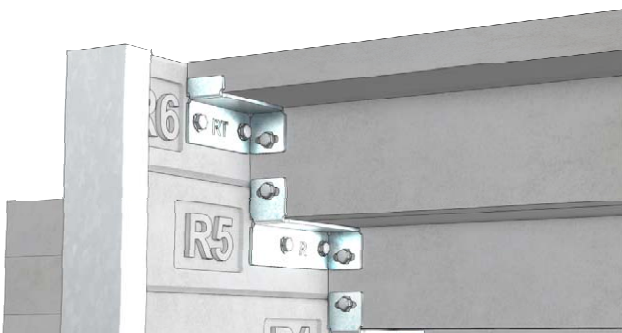

RT Bracket (Right Top Side) for top Level

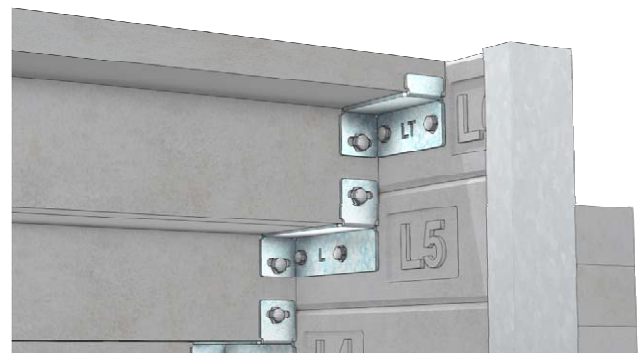

LT Bracket (Left Top Side) for top Level



For more information or support,
please contact one of our helpful staff on:

(08) 8280 9055

or visit:

www.silvercrete.com.au/help

